



ID CLAMPS

Make the Most of your Entire Workpiece!

ID expansion clamps expand to self-center and clamp on the inside diameter of a workpiece, leaving the outside clear for machining. Tightening the tapered center screw of ID clamps with a hex wrench pushes the clamping segments outward, and slightly downward, to exert force on the workpiece's internal bore. ID expansion Clamps allow close mounting for multi-part machining on vertical and horizontal machining centers.



**Find Pricing,
Application Info & More!**

- ID clamps are available in seven sizes to hold any inside diameter from .26" to 2.06".
- Carr Lane ID expansion clamps are proudly made in USA.

For maximum locational accuracy, machine a recess in the fixture base to fit exactly with the clamp's close-tolerance flange diameter. Flat-head mounting screws are furnished. Please note, ID Clamps provide mostly radial clamping force; therefore the workpiece must be firmly supported underneath – by resting directly on the clamp's mounting flange, the fixture base, or fixed rest pads.

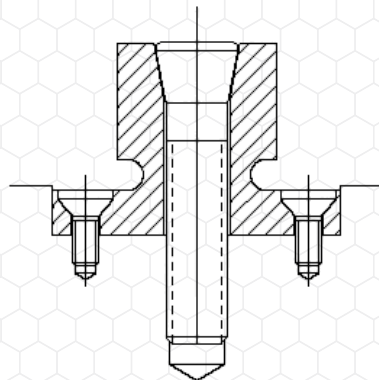

**Find Pricing,
Application Info & More!**